

LISTED
FOR FIRE
SPRINKLER
SYSTEMS

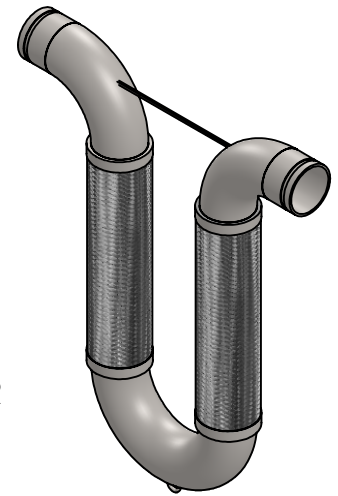

**MATERIALS OF
CONSTRUCTION**

END FITTINGS - 316 STAINLESS STEEL - SCH 40/STD WT
HOSE & BRAID - STAINLESS STEEL - 300 SERIES
90° ELBOW - 316 STAINLESS STEEL - SCH 40/STD WT
180° RETURN - 316 STAINLESS STEEL - SCH 40/STD WT

NOTE: HIGH PRESSURE HOSE AND BRAID
USED IN DESIGN OF 4", 5", AND 6" PARAMETERS

NOTE: METRALOOPS 2" AND LARGER INSTALLED IN ANY ORIENTATION OTHER THAN HANGING
DOWN MUST HAVE THE 180° RETURN SUPPORTED. (SEE INSTALLATION INSTRUCTIONS.)

CONTACT FACTORY FOR ADDITIONAL SIZES AND MOVEMENTS. ALL DIMENSIONS IN INCHES.

QTY	SIZE	MODEL	MOVEMENT	A	B	PSI	WT (LBS)	PROJECT INFO
	1" (25mm)	MLUGSS320100	±16"	27"	29"	300	8	
	1.25" (32mm)	MLUGSS320125	±16"	28"	32"	300	12	
	1.5" (40mm)	MLUGSS320150	±16"	29"	34"	300	14	
	2" (50mm)	MLUGSS320200	±16"	31"	39"	300	21	
	2.5" (65mm)	MLUGSS320250	±16"	33"	45"	300	34	
	3" (80mm)	MLUGSS320300	±16"	35"	48"	300	44	
	4" (100mm)	MLUGSS320400	±16"	40"	63"	300	70	
	5" (125mm)	MLUGSS320500	±16"	44"	62"	300	107	
	6" (150mm)	MLUGSS320600	±16"	48"	74.5"	300	157	
	8" (200mm)	MLUGSS320800	±16"	58"	78"	175	293	
	10" (250mm)	MLUGSS321000	±16"	68"	90"	175	534	
	12" (300mm)	MLUGSS321200	±16"	80"	102"	175	732	

SUITABLE FOR USE IN DRY PIPE SYSTEMS
FOR TEMPERATURES TO -40°F.

CUSTOMER: _____

PROJECT: _____

ENGINEER: _____

REV.	DATE
2323 W. HUBBARD ST. CHICAGO, IL 60612 TEL: 312-738-3800 WWW.METRAFIRE.COM	
METRAFLEX FIRELOOP™	
316 SS GROOVED ENDS, +/- 16" MOVEMENT	
DRAWN BY: JIMA	DATE: 8/6/2021
APPROVED: DKISH	DATE: 8/6/2021
SCALE: NONE	DRAWING NUMBER: MLUGSS32